



23/00684/FUL  
29/08/2023

- notes:
1. This drawing is Copyright reserved and should be used only for the purposes intended in its original issue.
  2. This drawing is to be read in conjunction with all relevant drawings and specifications including those from other Consultants.
  3. Any existing dimensions should be checked on site and any discrepancies reported to the Architect.
  4. Do not scale off this drawing, use only figured dimensions. The Contractor is to bring to the attention of the Architect any discrepancies contained in this drawing prior to work commencing.

-  Denotes existing plot boundary **551sq.m**
-  Denotes proposed new plot boundary **95sq.m (Total 646sq.m)**

Revision	Description	By	Chk
project			

**M & J Ballantyne Ltd**  
Proposed Alterations to  
Plot 65  
East Broomlands  
Kelso

title  
**Site Plan**  
**As Proposed**

scale	size	date	drawn	checked
1:200	A3	Apr 2023	CMF	

drawing status  
**PLANNING**

**AITKEN TURNBULL ARCHITECTS**  
9 Bridge Place  
Galashiels  
TD1 1SN  
01896 752760



enquiries@aitken-turnbull.co.uk  
www.aitken-turnbull.co.uk

Also at Edinburgh & Dumfries

project no.	drawing no.	revision
<b>AT3582</b>	<b>P65 L-101</b>	

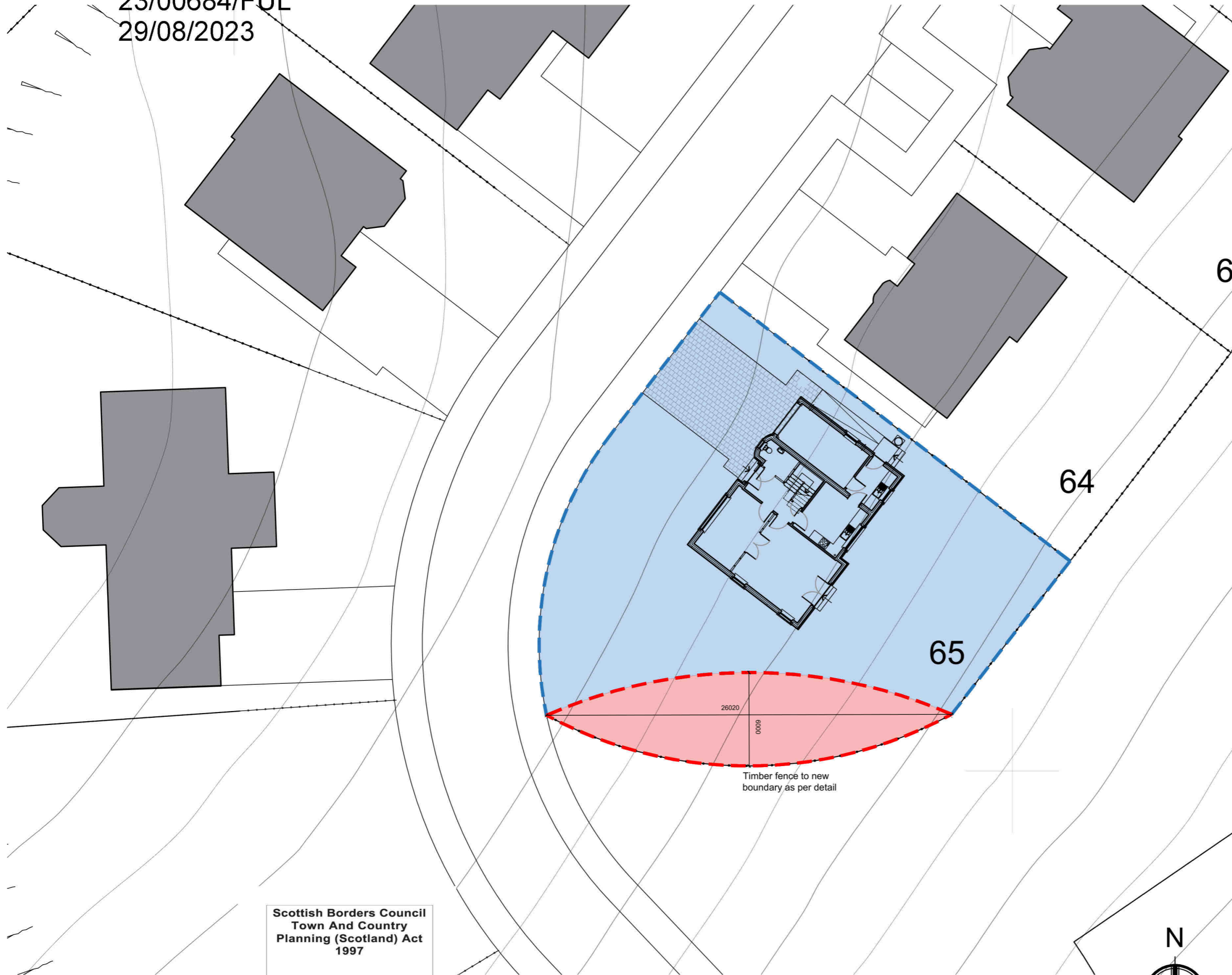

Timber fence to new boundary as per detail

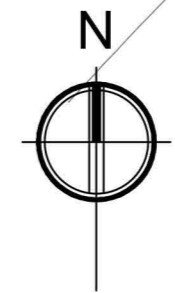

**Scottish Borders Council**  
**Town And Country**  
**Planning (Scotland) Act**  
**1997**

**REFUSED**

subject to the requirements of the associated Decision Notice

**Site Plan**



Scale 1:200

notes:

1. This drawing is Copyright reserved and should be used only for the purposes intended in its original issue.
2. This drawing is to be read in conjunction with all relevant drawings and specifications including those from other Consultants.
3. Any existing dimensions should be checked on site and any discrepancies reported to the Architect.
4. Do not scale off this drawing, use only figured dimensions. The Contractor is to bring to the attention of the Architect any discrepancies contained in this drawing prior to work commencing.

Timber Palisade Fence

Section

Elevation

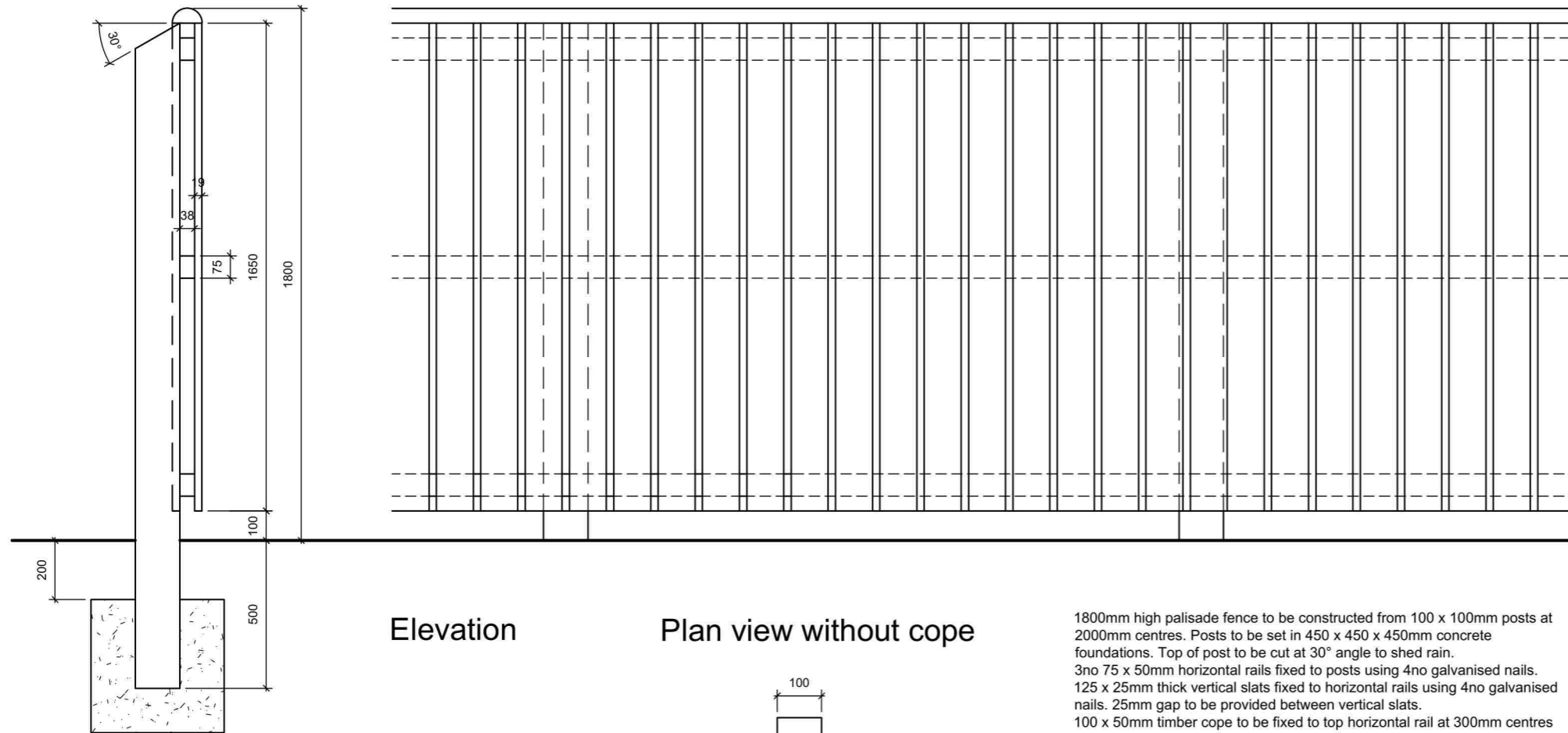

Elevation

Plan view without cope

1800mm high palisade fence to be constructed from 100 x 100mm posts at 2000mm centres. Posts to be set in 450 x 450 x 450mm concrete foundations. Top of post to be cut at 30° angle to shed rain.  
3no 75 x 50mm horizontal rails fixed to posts using 4no galvanised nails.  
125 x 25mm thick vertical slats fixed to horizontal rails using 4no galvanised nails. 25mm gap to be provided between vertical slats.  
100 x 50mm timber cope to be fixed to top horizontal rail at 300mm centres using galvanised nails.

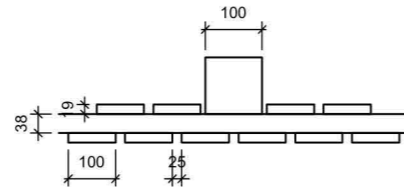

Section

Site Plan

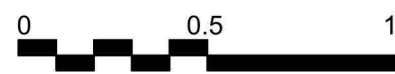

Scale 1:20

Scottish Borders Council  
Town And Country  
Planning (Scotland) Act  
1997

**REFUSED**

subject to the  
requirements of the  
associated Decision  
Notice

Revision	Description	By	Chk
project			

M & J Ballantyne Ltd  
Proposed Alterations to  
Plot 65  
East Broomlands  
Kelso

title  
Fence Details  
As Proposed

scale	size	date	drawn	checked
1:20	A3	Apr 2023	CMF	

drawing status  
PLANNING

AITKEN TURNBULL ARCHITECTS  
9 Bridge Place  
Galashiels  
TD1 1SN  
01896 752760

enquiries@aitken-turnbull.co.uk  
www.aitken-turnbull.co.uk

Also at Edinburgh & Dumfries



project no.	drawing no.	revision
AT3582	P65 L-102	

**REFUSED**

subject to the  
requirements of the  
associated Decision  
Notice

23/00684/FUL  
29/08/2023

notes:

1. This drawing is Copyright reserved and should be used only for the purposes intended in its original issue.
2. This drawing is to be read in conjunction with all relevant drawings and specifications including those from other Consultants.
3. Any existing dimensions should be checked on site and any discrepancies reported to the Architect.
4. Do not scale off this drawing, use only figured dimensions. The Contractor is to bring to the attention of the Architect any discrepancies contained in this drawing prior to work commencing.

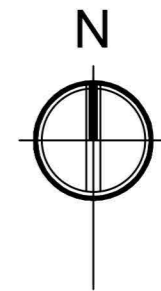

Revision	Description	By	Chk
A	May2023 Areas amended		

**M & J Ballantyne Ltd**  
Proposed Alterations to Plot 65  
East Broomlands  
Kelso

title  
**Location Plan**

scale	size	date	drawn	checked
1:1250	A3	Apr 2023	CMF	

drawing status

**AITKEN TURNBULL ARCHITECTS**  
9 Bridge Place  
Galashiels  
TD1 1SN  
01896 752760

enquiries@aitken-turnbull.co.uk  
www.aitken-turnbull.co.uk

Also at Edinburgh & Dumfries



project no.	drawing no.	revision
AT3582	P65 LOC	A

